

Allbrite UK Ltd  
30 Chester Street  
Mold  
Flintshire  
CH7 1EG

Thermostat Helpline: 01352 757557  
[www.allbriteuk.co.uk](http://www.allbriteuk.co.uk) [sales@allbriteuk.co.uk](mailto:sales@allbriteuk.co.uk)

## Operating Instructions

Allbrite Combi  
A/F/AF

Allbrite Combi  
A/F/AF Network



## Contents

Contents	1
Installation	2-4
Button & LCD Layout	5&6
Symbols Explained	6
Feature Table	7-8
Features Explained	9-10
Setting up the Features	11
Temperature Display	10
Setting the Clock	11
Temperature Override	11
Frost Mode	11
Setting the Comfort Levels	12-13
Keylock	14
Viewing the Floor Temperature	14
<b>Wiring</b>	
A/F/AF Wiring Diagram	15
A/F/AF Network Wiring Diagram	16

## 1. Installation

1. The thermostat is flush mount, a back box of 35mm should have been fitted in the wall prior to installation.
2. The thermostat should be mounted at around 1.5 meters or eye level
3. Do not install near a direct heat source.

### Step 1

Carefully separate the front half of the thermostat from the back plate by placing a small flat head terminal driver in to the slots on the bottom face of the thermostat.

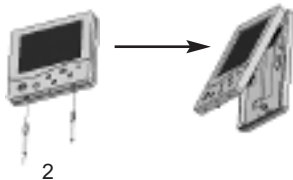

## Step 2

Carefully unplug the ribbon connector which is plugged in to the front half of the thermostat.

Place the thermostat front half somewhere safe.

Connect the thermostat as shown in the diagrams at the back of this booklet.

Screw the thermostat back plate on to the back box.

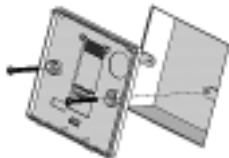

### Step 3

Re-connect the thermostat ribbon cable and clip the two halves together.

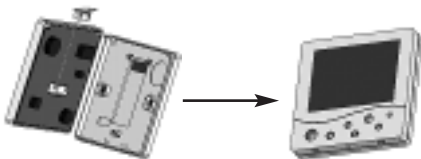





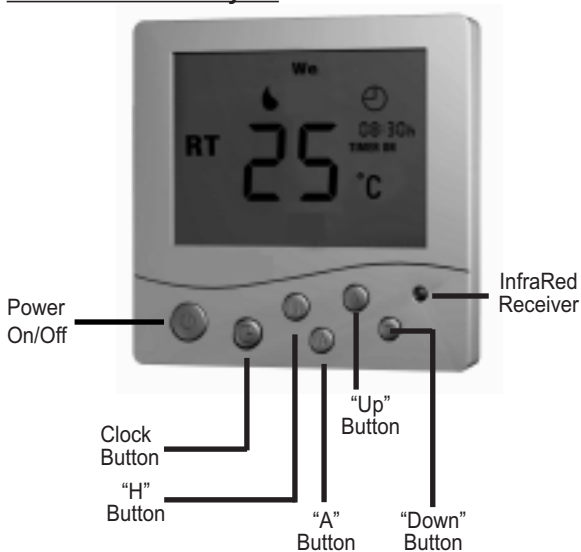

### Step 4

Turn on the power to the thermostat and allow the thermostat to stabilise for 1 hour before calibrating.

## 2. Button & LCD Layout



	<b>LCD Symbols</b>
	Clock Indicator
	Heat Active Indicator
	Frost Mode On
	Floor Temperature Over Limit
	KeyLock On
 Flashing	Optimum Start Mode Active

## Features Explained

**Switching Differential:** This is the number of degrees the heating switches back on below the set temperature.

**Temperature Calibrate:** Use this function to calibrate the thermostat to your digital thermometer.

**Frost Mode:** You can set whether the thermostat will maintain the frost temperature even when the display has been turned off with the power button. As a default, this is enabled.

**Frost Protection Temperature:** Used to set the required frost temperature.

**Output Delay:** To prevent rapid switching, an output delay can be entered.

**Optimum Start:** Optimum start function works on comfort level 1 only. The function calculates the amount of preheat required in order to get the building up to temperature by the programmed time.

## Features Continued

**Rate of Change:** This setting is calculated by the thermostat and the reading is not adjustable by the user.

**Air Sensor Selection:** You can select whether the air sensor used is the one built in to the thermostat or a remote probe. This option is only available when the Control Mode is set as type 2 or 5 (See table on page 9)

**Floor Sensor Enable/Disable:**

The floor sensor is used to protect the floor surface. During normal operation, the thermostat will maintain the air temperature from the room sensor, but should the floor temperature limit be exceeded the heating will turn off. This option is only available when the Control Mode is set as type 2 or 5 (See table on page 9)

**Floor Temperature Limit:** 20-45°C

This option is only available when the Control Mode is set as type 2 or 5 (See table on page 9)

## **Feature Table**



Feature	Description	Setting
01	Not used on this model	
02	Switching Differential	01=1°C, 02=2°C, 03=3°C (01 = Default)
03	Temperature Calibrate	Enter Value
04	Frost Mode	00=Disabled 01=Enabled (01 = Default)
05	Frost Protection Temp	07-17°C (12°C Default)
06	Output Delay	Enter Value 30seconds Default
07	Comms # (Network only)	Enter number 01-32
08	Optimum Start (Preheat)	00=Disabled (Default) 01=01 hr 02=02 hr 03=03 hr
09	Rate of Change	For information only,
10	Air Sensor Selection (Modes 2&5 Only)	00=Internal (Default) 01=Remote
11	Floor Sensor - (Modes 2 & 5 only)	00=Disabled 01 Enabled (Default)
12	Floor Limit Setting (Modes 2 & 5 only)	20-45°C (28°C Default)



## **Setting up the Features:**

With the thermostat turned off, press  for 3 seconds  
On the LCD you will see 01(small) to the top right, and 00 (large) in  
the centre.

Small setting = Feature #    Large setting = Setting

- Use the Up/Down arrow key to change the setting.
- Press  to accept and proceed to the next feature.
- Press  to store and exit.

You should set this in conjunction with the Feature Tables shown on  
pages 9&10

## Temperature Display

- RT = Current room temperature  
SET = Set temperature, displayed when you are adjusting the temperature setting.

## Setting the Clock

To set the clock within the thermostat, follow the steps below.

**Important Note:** This option is not available when the Control Mode (See Page 10) has been set to non programmable modes (Modes 0,1,2)

- With the thermostat turned on, press  twice
- You are now able to set the minutes using the up/down keys
- Press H to accept
- You are now able to set the hours using the up/down keys
- Press H to accept
- You are now able to set the day of the week using the up/down keys
- Press A to store and exit

The clock is now set. The thermostat has a battery which maintains the clock on a power failure. All program settings are retained in flash memory for 10 years.

## **Temperature Override**

Using the Up/Down arrow keys you can adjust the current set temperature. On the screen, you will see SET and the new temperature displayed.

This temperature will be maintained until the next programmed comfort level.

Press A to accept and exit.

## **Frost Mode**

By pressing the "H" button, the thermostat will switch into frost protection mode. You will see  on screen.

The frost protection temperature will now be maintained. To cancel press H. To change the frost temperature setting, see page 7.

## Setting the Comfort Levels

**Important Note:** Not applicable to Control Modes 0,1,2

The thermostat has 4 comfort levels for the weekday and 4 for the weekend. This method of control is not to have on/off times but to allow the occupant to set varying temperatures throughout the day.

For example;

08.00 - 21°C (Wake) 09.30 - 16°C (Go to work)  
16.30 - 22°C (Return home) 23.00 - 17°C (Sleep)

You are now able to program the first comfort level for the weekday.

Follow these steps;

- To begin programming the comfort levels, press  once. You will see Mo - Fr displayed.
- Use the Up/Down arrow keys to select the time for the 1st comfort level for the weekday.
- Press H to accept
- Enter the required temperature for the 1st comfort level.
- Repeat for comfort levels 2-4.
- If you only want to use 2 levels, you should program the unused levels to --.--
- You will now see Sa Su on the screen. Repeat for the comfort levels for the weekend.
- Press A to store and exit.

## **Enabling Keylock**

The thermostat has a keylock facility. To enable this press the “A” and “UP” arrow key for 10 seconds.

When the keylock function has been activated, you will see  on screen.

To cancel, repeat the steps above.

## **Viewing The Current Floor Temperature**

Only available when Control Mode is set to 2 & 5

Press the “A” button for 3 seconds, the floor temperature will be displayed. After 30 seconds the display will return to show the “RT” temperature. To return to the room temperature display, press H.

## 240v Version - Wiring

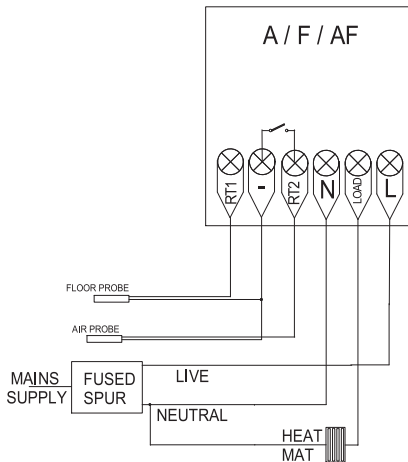

## 12v Network Version - Wiring

Absolute maximum rating 16 Amps

For prolonged use above 13 Amps (3kw)  
we recommend the use of a contactor

To reduce the possibility of interference when  
extending the sensor probe cables please use  
screened cables

